

Design meets the requirements of PED 97/23/EC and harmonized standards

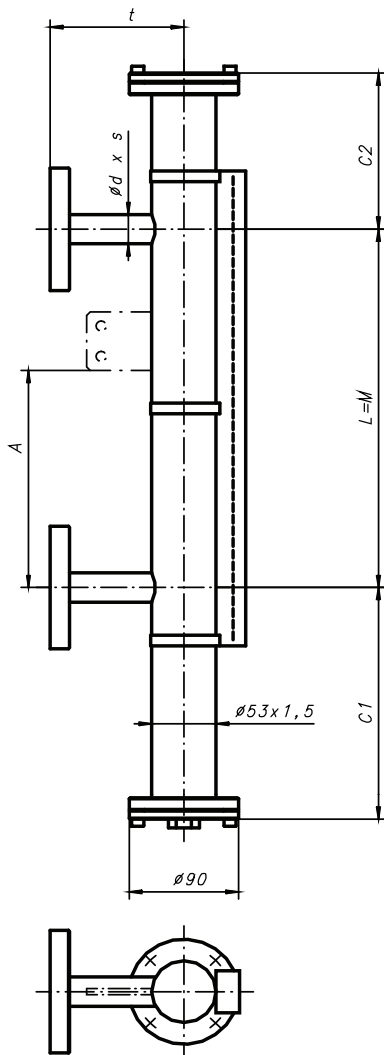

**Purchase Order Data:**

Company:	Project:
Purchase order no.:	
Quantity:	Tag no.:

**Operating Conditions**

Fluid:		
Density:	≥ 0.65g/cm3	g/cm3:
Viscosity:	≤ 600cSt	cSt:
Operating pressure:	max. 6bar(g) @ 20°C *1)	bar(g):
Design pressure:	"	bar(g):
Operating temperature:	-80°C ... +150°C *1)	°C:
Design temperature:	"	°C:
Connecting Distance "L":	max. 5600mm (one-piece design)	mm:

**Design and Materials:**

Float chamber:	316/316L	Screws and nuts:	A2-70, ISO 3506
Float:	316L (Standard)	type no.:	36223/20 / 38662/20
	NBR	type no.:	39525/0.8 /1.0 /1.2
		type no.:	

other materials and densities see float selection diagram or on request

Damping spring top and bottom, 1.4401	No.:	27399	<input type="checkbox"/>
Gaskets:	Fibre compound Aramid/NBR (<150°C)	Standard	<input type="checkbox"/>
	PTFE, non reinforced, raked (<250°C)		<input type="checkbox"/>
	Graphite incl. reinforcing net in ss 316/316L (<400°C)		<input type="checkbox"/>

**Process connections:**

<b>EN-Connecting Flanges acc. EN1092-1 (Standard):</b>	DN15:	<input type="checkbox"/>
- EN1092-1/01 A/DNxx/PN40/316L	DN20:	<input type="checkbox"/>
- plate flanges, FF, Rz=12,5 ... 50µm, turning	DN25:	<input type="checkbox"/>

**ANSI/class150 (= ISO/PN20) - connecting flanges:**

- ANSI/ASME B16.5 / ISO-DIS7005-1.2, type 01/B1	ANSI 1/2" resp. ISO DN15 :	<input type="checkbox"/>
- plate flanges, RF SF, Rz=12,5 ... 50µm, turning	ANSI 3/4" resp. ISO DN20 :	<input type="checkbox"/>
	ANSI 1" resp. ISO DN25 :	<input type="checkbox"/>

**Other Connections**

	<input type="checkbox"/>
--	--------------------------

**Drain connection thread (Standard) (for vent see price list):**

G3/8" (ISO7-1/ISO228-1) with plug R3/8" (ISO7-1) and PTFE tape (<=250°C)	<input type="checkbox"/>
G3/8" (ISO7-1/ISO228-1) with plug G3/8" (ISO228-1) and NiCu gasket (>250°C)	<input type="checkbox"/>

**Indication Rail:**

PC, IP65 (<150°C)	Flaps: red-silver	No.:	34837	Standard	<input type="checkbox"/>
PC, IP68, inert gas (<150°C)	Flaps: red-silver	No.:	41008		<input type="checkbox"/>
Al/PC, IP54 (<250°C)	Flaps: red-silver	No.:	34560		<input type="checkbox"/>
Al/glass, IP54 (<400°C)	Flaps: black-silver	No.:	37100		<input type="checkbox"/>
Special	Flaps:	No.:			<input type="checkbox"/>

**Accessories (installation instructions see spec. no. 20010501)**

Fixation bracket no. 26936:	dimension "A" [mm]:	<input type="text"/>
Magnetic switch:	quantity:	<input type="text"/>
Transmitter:	resolution [mm]:	5 / 10
	measuring length M <sub>el.</sub> [mm]:	<input type="text"/>
Converter:	type:	<input type="text"/>
Further accessories:		<input type="text"/>

**Test reports and certificates:**

EN10204:2004-3.1 certificate for used materials of the float chamber:	<input type="checkbox"/>
---	--------------------------

**Special executions and notes:**

	<input type="text"/>
--	----------------------

**Float extension lower / upper:**

	<b>C1:</b>	<b>C2:</b>
Standard	180	130

C1 & C2 shorter or longer, if out of standard range or with damping springs

**Standard flange connections:**

	EN	ANSI/ISO
Connection pieces, d*s:		
DN15:	21.3*2.0	21.3*2.0
DN20:	26.9*2.0	26.9*2.0
DN25:	33.7*2.0	33.7*2.0
≥ DN32 *2):	33.7*2.0	33.7*2.0

**Dimension t:**

DN15:	110	110
DN20:	110	110
DN25:	110	110
≥ DN32 *2):	tba on request 3):	

**Notes:**

\*1) Refer to pressure-temperature rating! Lowest pressure-temperature rating of any connecting flange or fitting will set the limitation!  
Test pressure will be specified according to WEKA specification AW 2.1.2.

\*2) With special reduction flanges.

\*3) Depending on size of connecting flanges.

All indicated dimensions in mm. All dimensions are only valid on VLI in standard execution.