

Design meets the requirements of PED 97/23/EC and harmonized standards

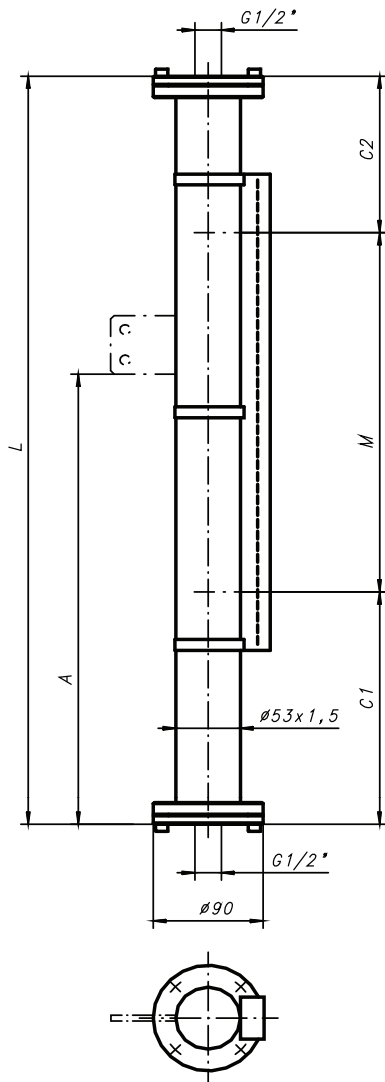

Float extension lower / upper:

	C1:	C2:
Standard	180	130

C1 & C2 shorter or longer, if out of standard range or with damping springs

Purchase Order Data:

Company:	Project:
Purchase order no.:	
Quantity:	Tag no.:

Operating Conditions

Fluid:		
Density:	≥ 0.65g/cm3	g/cm3:
Viscosity:	≤ 600cSt	cSt:
Operating pressure:	max. 6bar(g) @ 20°C *1)	bar(g):
Design pressure:	"	bar(g):
Operating temperature:	-80°C ... +150°C *1)	°C:
Design temperature:	"	°C:
Connecting Distance "L":	max. 5800mm (one-piece design)	mm:

Design and Materials:

Float chamber:	316/316L	Screws and nuts:	A2-70, ISO 3506
Float:	316L (Standard)	type no.:	36223/20 / 38662/20
	NBR	type no.:	39525/0.8 / 1.0 / 1.2
		type no.:	

other materials and densities see float selection diagram or on request

Damping spring top and bottom, 1.4401	No.: 27399	<input type="checkbox"/>
Gaskets:	Fibre compound Aramid/NBR (<150°C)	Standard <input type="checkbox"/>
	PTFE, non reinforced, racked (<250°C)	<input type="checkbox"/>
	Graphite incl. reinforcing net in ss 316/316L (<400°C)	<input type="checkbox"/>

Process connections:

Connection threads:

- female G1/2" (ISO 7-1 / ISO 228-1), without plug Standard
- other connection threads see price list

Indication Rail:

PC, IP65 (<150°C)	Flaps: red-silver	No.: 34837	Standard <input type="checkbox"/>
PC, IP68, inert gas (<150°C)	Flaps: red-silver	No.: 41008	<input type="checkbox"/>
Al/PC, IP54 (<250°C)	Flaps: red-silver	No.: 34560	<input type="checkbox"/>
Al/glass, IP54 (<400°C)	Flaps: black-silver	No.: 37100	<input type="checkbox"/>
Special	Flaps: <input type="text"/>	No.: <input type="text"/>	<input type="checkbox"/>

Accessories (installation instructions see spec. no. 20010501)

Fixation bracket no. 26936:	dimension "A" [mm]:	<input type="text"/>
Magnetic switch:	quantity:	type:
Transmitter:	resolution [mm]:	type:
	measuring length M _{el} [mm]:	
Converter:	type:	
Further accessories:	<input type="text"/>	

Test reports and certificates:

EN10204:2004-3.1 certificate for used materials of the float chamber:

Special executions and notes:

Notes:

*1) Refer to pressure-temperature rating! Lowest pressure-temperature rating of any connecting flange or fitting will set the limitation!
Test pressure will be specified according to WEKA specification AW 2.1.2.