

Design meets the requirements of PED 97/23/EC and harmonized standards

Purchase Order Data:

Company: Project:
 Purchase order no.:
 Quantity: Tag no.:

Operating Conditions

Fluid:
 Density: $\geq 0.55\text{g/cm}^3$ g/cm3:
 Viscosity: $\leq 600\text{cSt}$ cSt:
 Operating pressure: max. 50bar(g) @ 20°C *1) bar(g):
Design pressure: " bar(g):
 Operating temperature: -80°C ... +400°C *1) °C:
Design temperature: " °C:
 Connecting Distance "L": max. 5800mm (one-piece design) mm:

Design and Materials:

Float chamber: 316/316L Screws and nuts: A2-70, ISO 3506
 Float: Ti alloy (Standard) type no.: **37943-2 / -3 / -4**
 type no.:
 other materials and densities see float selection diagram or on request

Damping spring top and bottom, 1.4401 No.: 27399
 Gaskets: Fibre compound Aramid/NBR (<150°C) Standard
 PTFE, non reinforced, raked (<250°C)
 Graphite incl. reinforcing net in ss 316/316L (<400°C)

Process connections:

Connection threads:
 - female G1/2" (ISO 7-1 / ISO 228-1), without plug Standard
 - other connection threads see price list

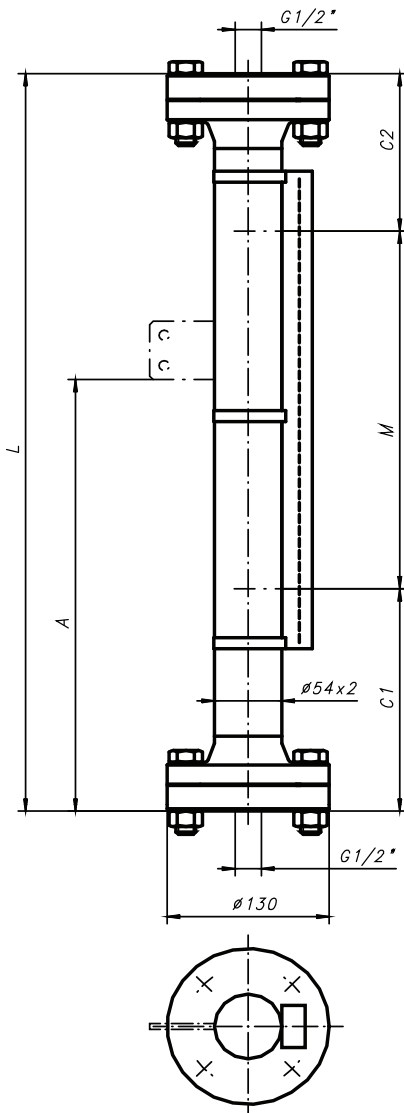

Float extension lower / upper:

Standard C1: 190 C2: 140

C1 & C2 shorter or longer, if out of standard range or with damping springs

Indication Rail:

PC, IP65 (<150°C) Flaps: red-silver No.: 34837 Standard
 PC, IP68, inert gas (<150°C) Flaps: red-silver No.: 41008
 Al/PC, IP54 (<250°C) Flaps: red-silver No.: 34560
 Al/glass, IP54 (<400°C) Flaps: black-silver No.: 37100
 Special Flaps: No.:

Accessories (installation instructions see spec. no. 20010501)

Fixation bracket no. 26936: dimension "A" [mm]:
 Magnetic switch: quantity: type:
 Transmitter: resolution [mm]: **5 / 10** type:
 measuring length M_{el} [mm]:
 Converter: type:
 Further accessories:

Test reports and certificates:

EN10204:2004-3.1 certificate for used materials of the float chamber:

Special executions and notes:

Notes:

*1) Refer to pressure-temperature rating! Lowest pressure-temperature rating of any connecting flange or fitting will set the limitation! Test pressure will be specified according to WEKA specification AW 2.1.2.

All indicated dimensions in mm. All dimensions are only valid on VLI in standard execution.